









Legenda:

-  Cavo di rete già cablato

 Switch PoE+ 12 porte
-  Stampante multifunzione

 Armadio Rack da installare
-  Personal Computer

 Armadio Rack già esistente
-  Modem ADSL







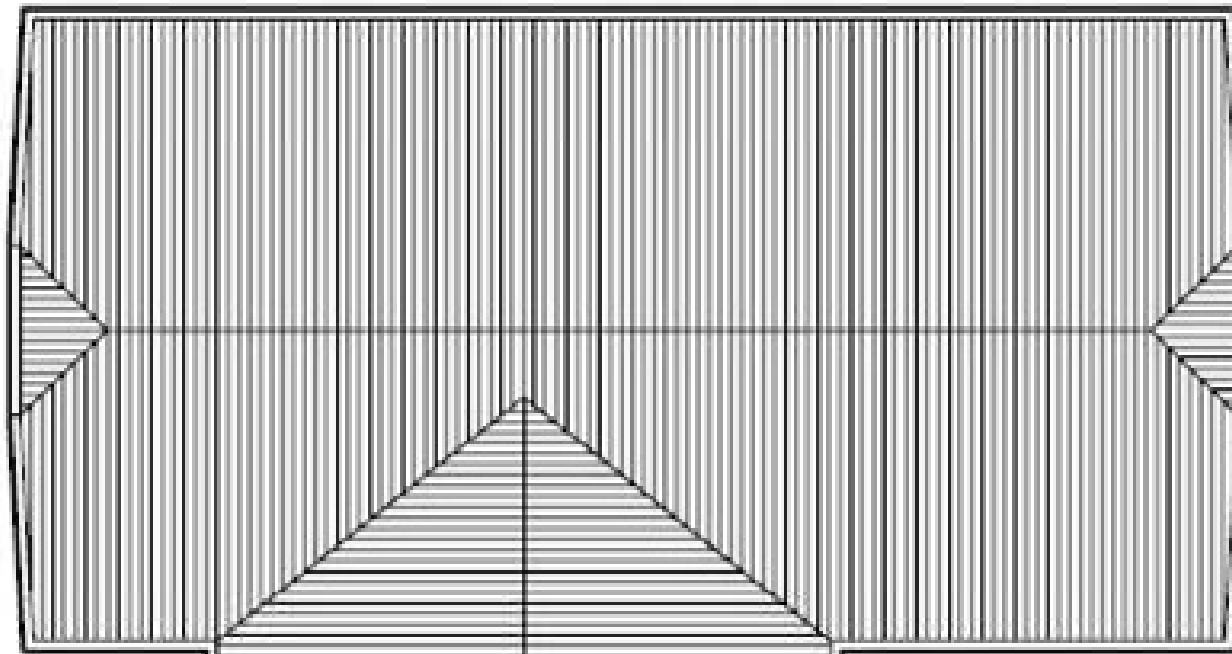

 Access Point PoE dual Band
-  Cavo di rete cat. 6 da cablare

L'impianto non necessita di posa in opera di canaline per il passaggio dei cavi

Si fa presente che in questo plesso esiste già un cablaggio con cavo a 2 coppie che dal piano 1° arriva in tutte le aule.



Legenda:

- | | | | |
|---|--------------------------------|---|--|
|  | Cavo di rete già cablato |  | Switch PoE+ 12 porte |
|  | Stampante multifunzione |  | Armadio Rack da installare 6U con multiplexa |
|  | Personal Computer |  | Armadio Rack già esistente |
|  | Modem |  | Access Point PoE dual Band |
|  | Cavo di rete cat. 6 da cablare | | |





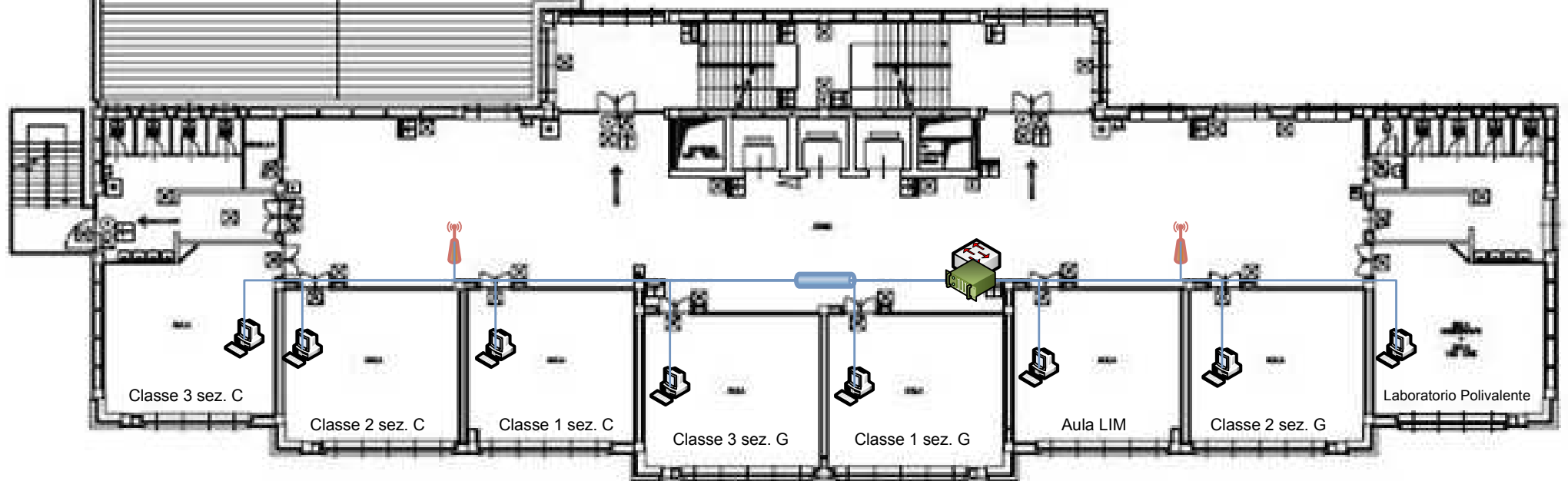

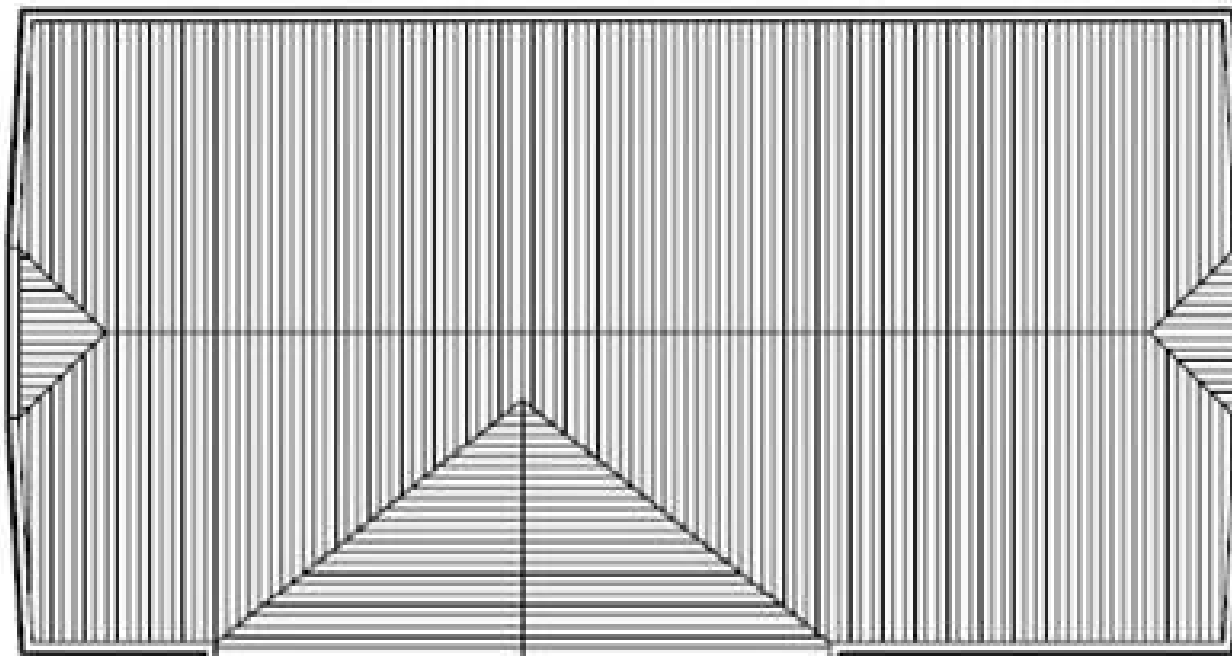

L'impianto non necessita di posa in opera di canaline per il passaggio dei cavi

Si fa presente che in questo plesso esiste già un cablaggio con cavo a 2 coppie che dal piano 1° arriva in tutte le aule.





Legenda:

- | | | | |
|---|--------------------------------|---|-----------------------------------|
|  | Cavo di rete già cablato |  | Switch PoE+ 12 porte |
|  | Stampante multifunzione |  | Armadio Rack da 6U con multipresa |
|  | Personal Computer |  | Armadio Rack già esistente |
|  | Modem |  | Access Point PoE dual Band |
|  | Cavo di rete cat. 6 da cablare | | |





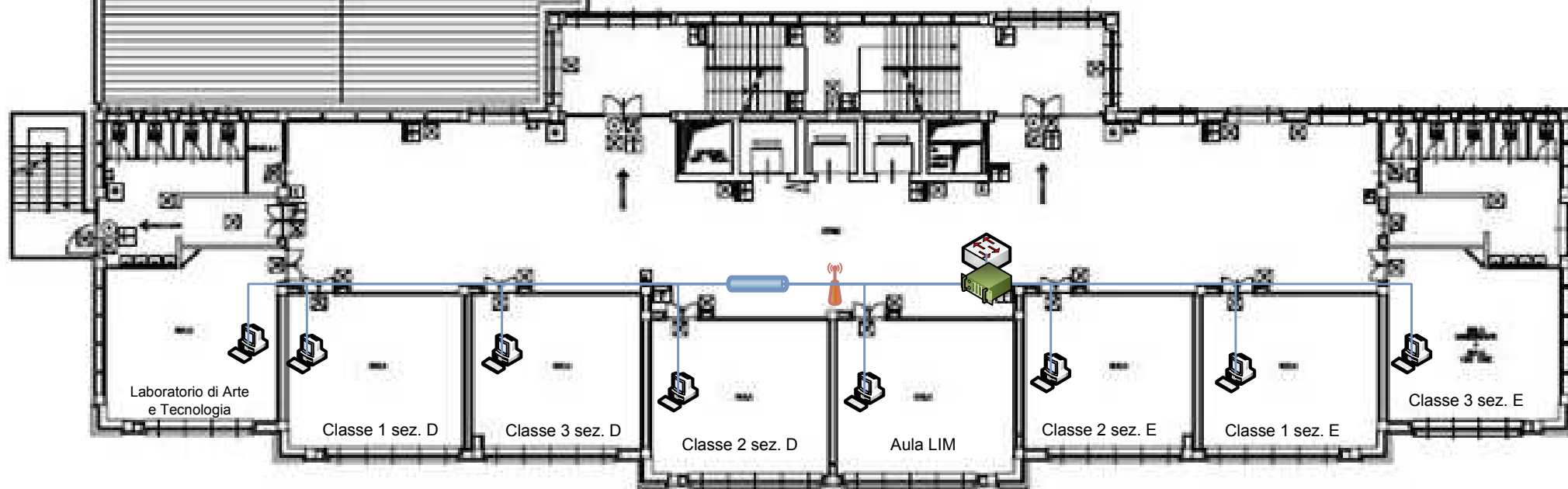

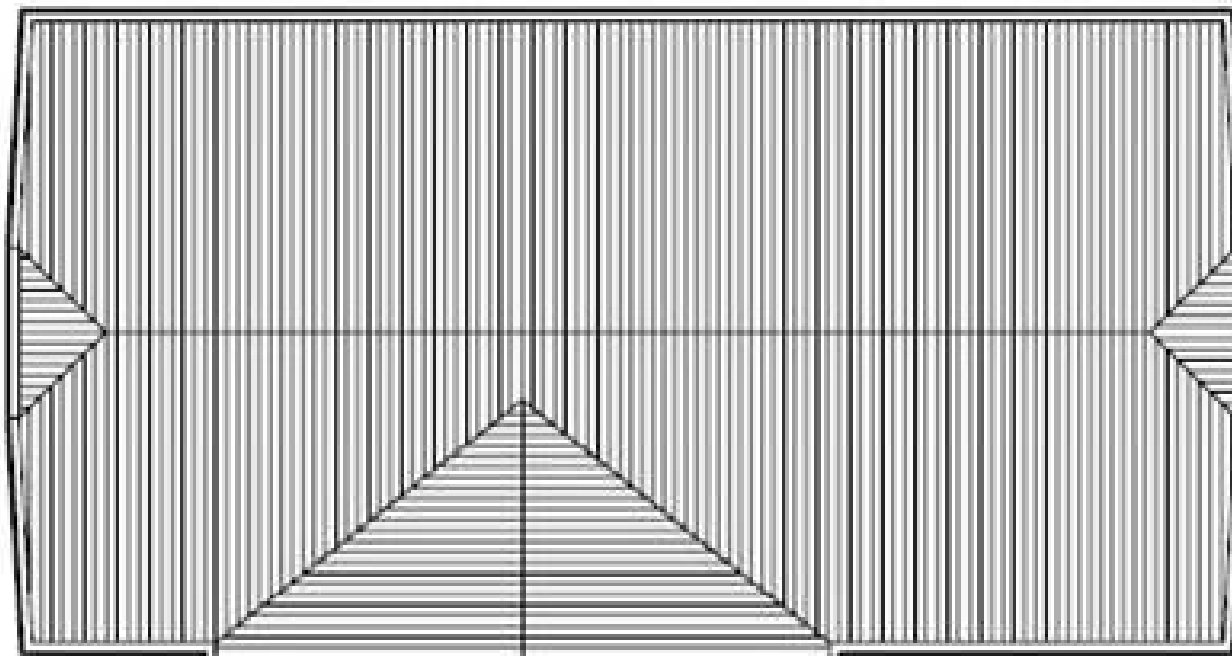

L'impianto non necessita di posa in opera di canaline per il passaggio dei cavi

Si fa presente che in questo plesso esiste già un cablaggio con cavo a 2 coppie che dal piano 1° arriva in tutte le aule.





Legenda:





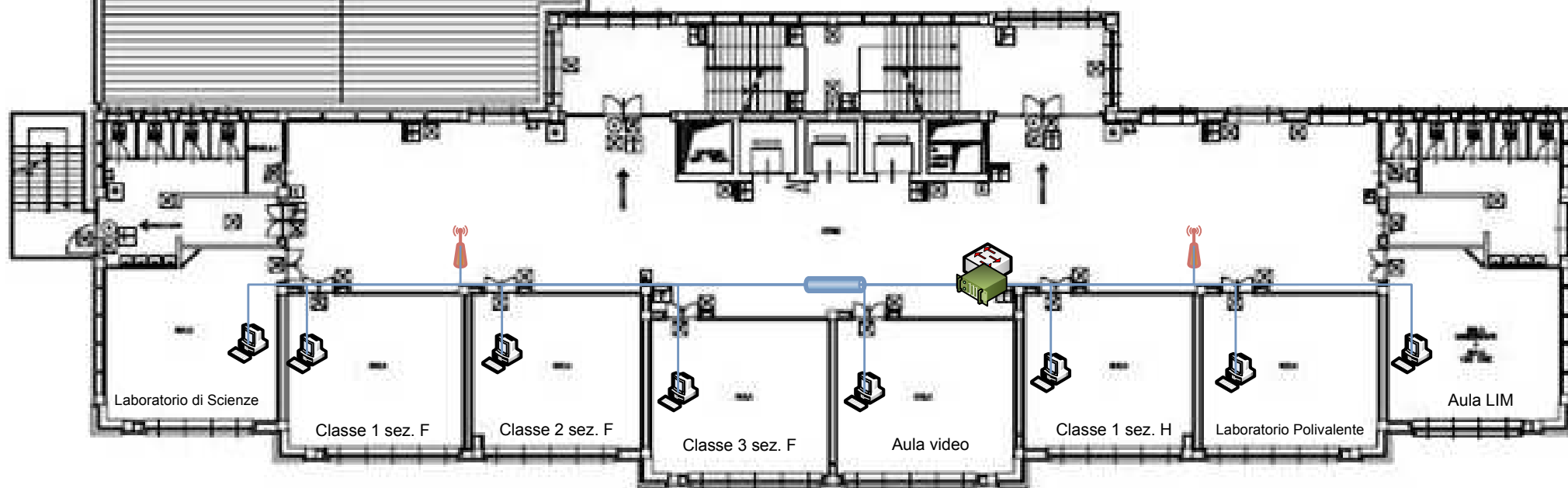

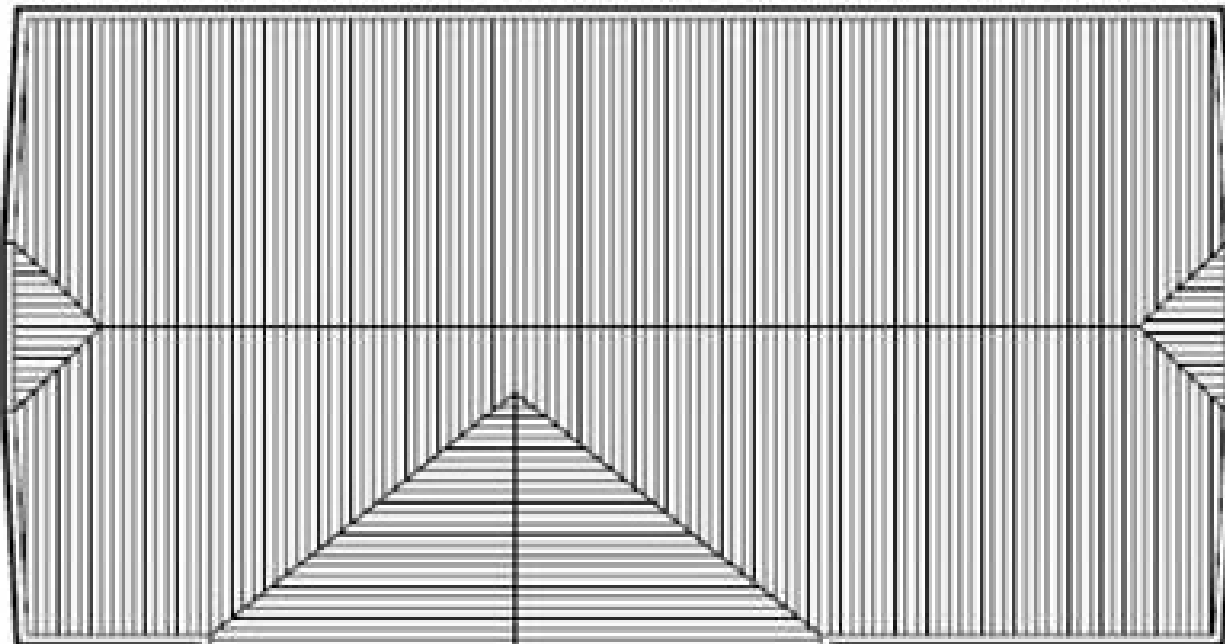

- | | | | |
|---|--------------------------------|---|-----------------------------------|
|  | Cavo di rete già cablato |  | Switch PoE+ 16 porte |
|  | Stampante multifunzione |  | Armadio Rack da 6U con multipresa |
|  | Personal Computer |  | Armadio Rack già esistente |
|  | Modem |  | Access Point PoE dual Band |
|  | Cavo di rete cat. 6 da cablare | | |

L'impianto non necessita di posa in opera di canaline per il passaggio dei cavi
 Si fa presente che in questo plesso esiste già un cablaggio con cavo a 2 coppie che dal piano 1° arriva in tutte le aule.





Legenda:

-  Cavo di rete già cablato
-  Stampante multifunzione
-  Personal Computer
-  Modem
-  Cavo di rete cat. 6 da cablare proveniente dallo Switch del piano inferiore
-  Switch PoE+ 12 porte
-  Armadio Rack da installare
-  Armadio Rack già esistente
-  Access Point PoE dual Band

L'impianto non necessita di posa in opera di canaline per il passaggio dei cavi

Si fa presente che in questo plesso esiste già un cablaggio con cavo a 2 coppie che dal piano 1° arriva in tutte le aule.

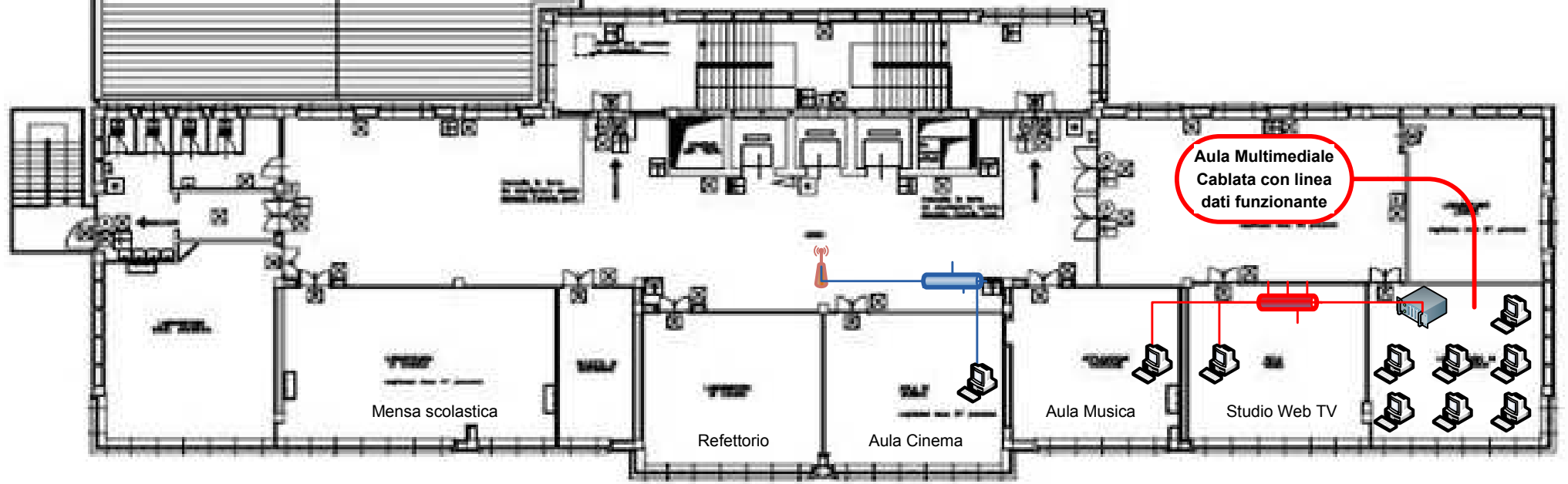

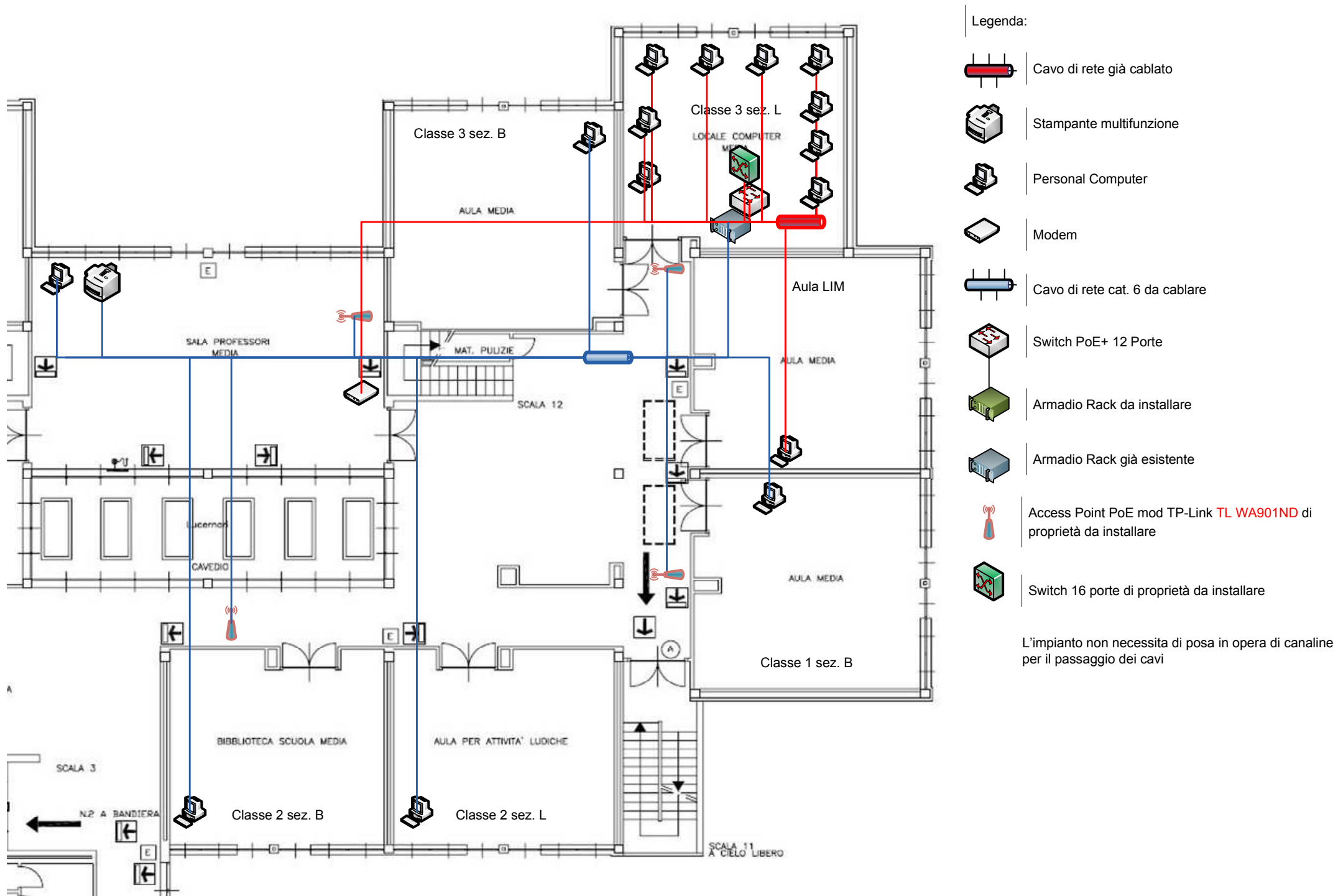

Legenda:

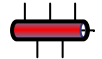

Cavo di rete già cablato



Cavo di rete cat. 6 da cablare



Stampante multifunzione



Switch PoE+ 12 Porte



Personal Computer



Armadio Rack da installare



Modem



Access Point dual Band PoE







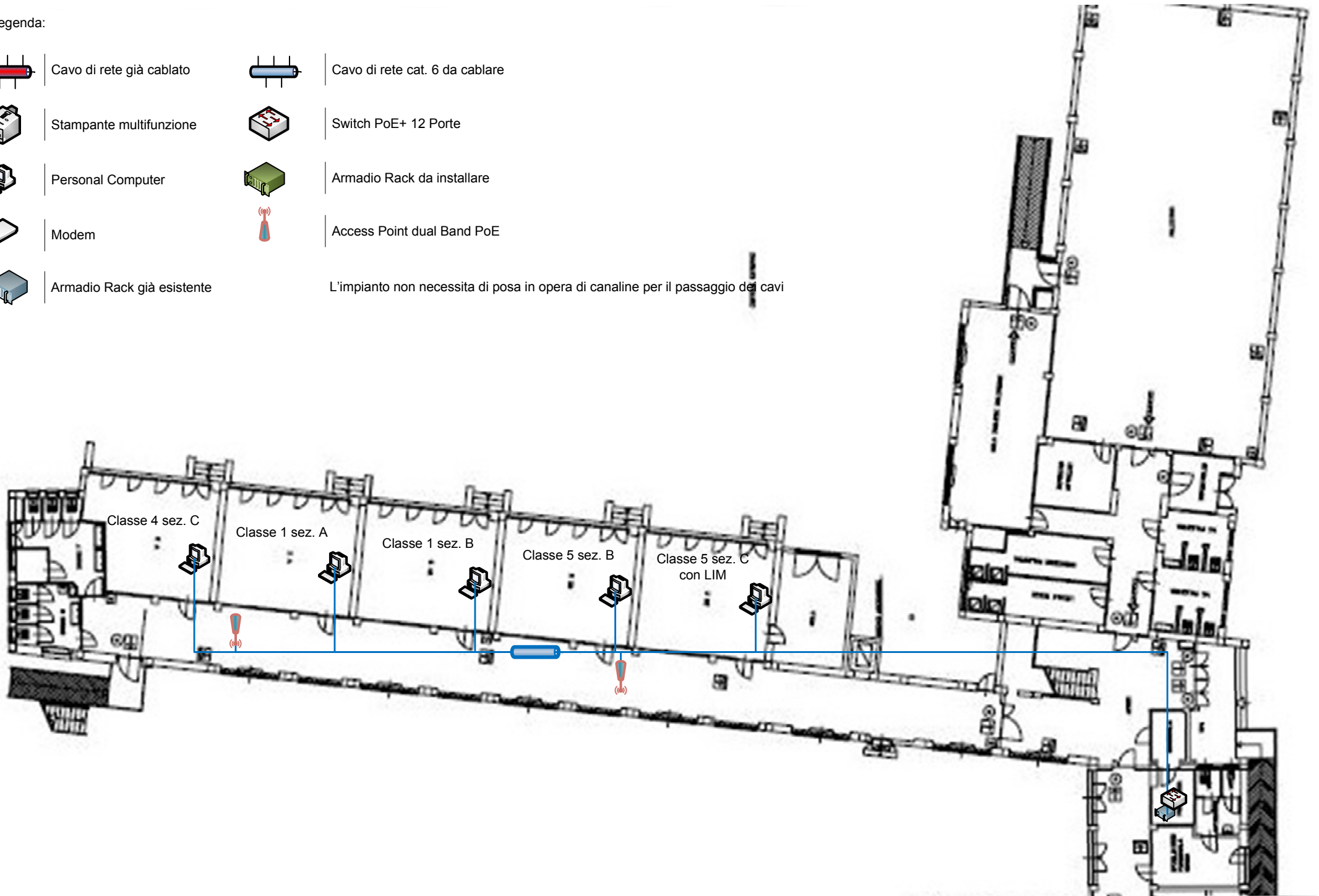

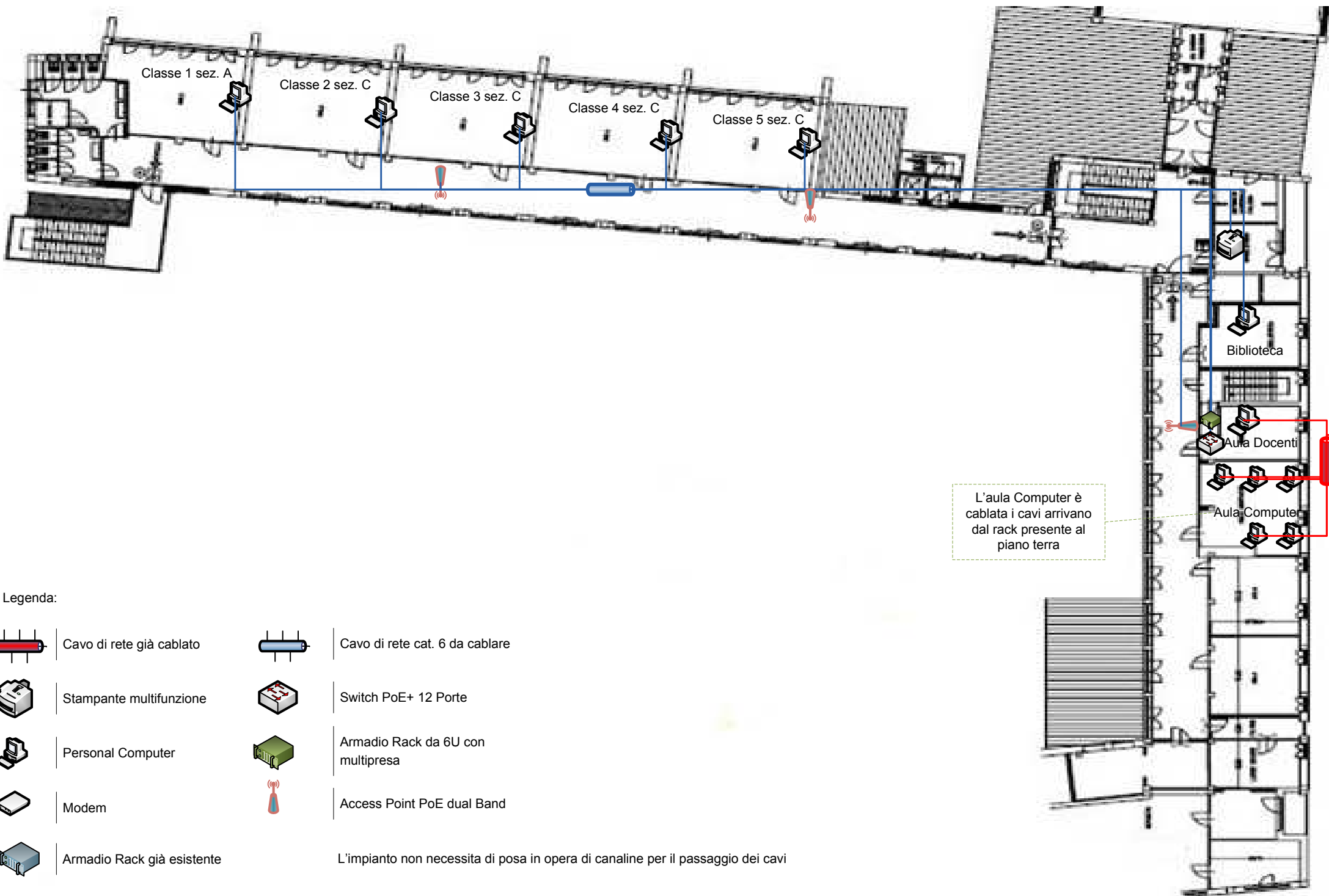

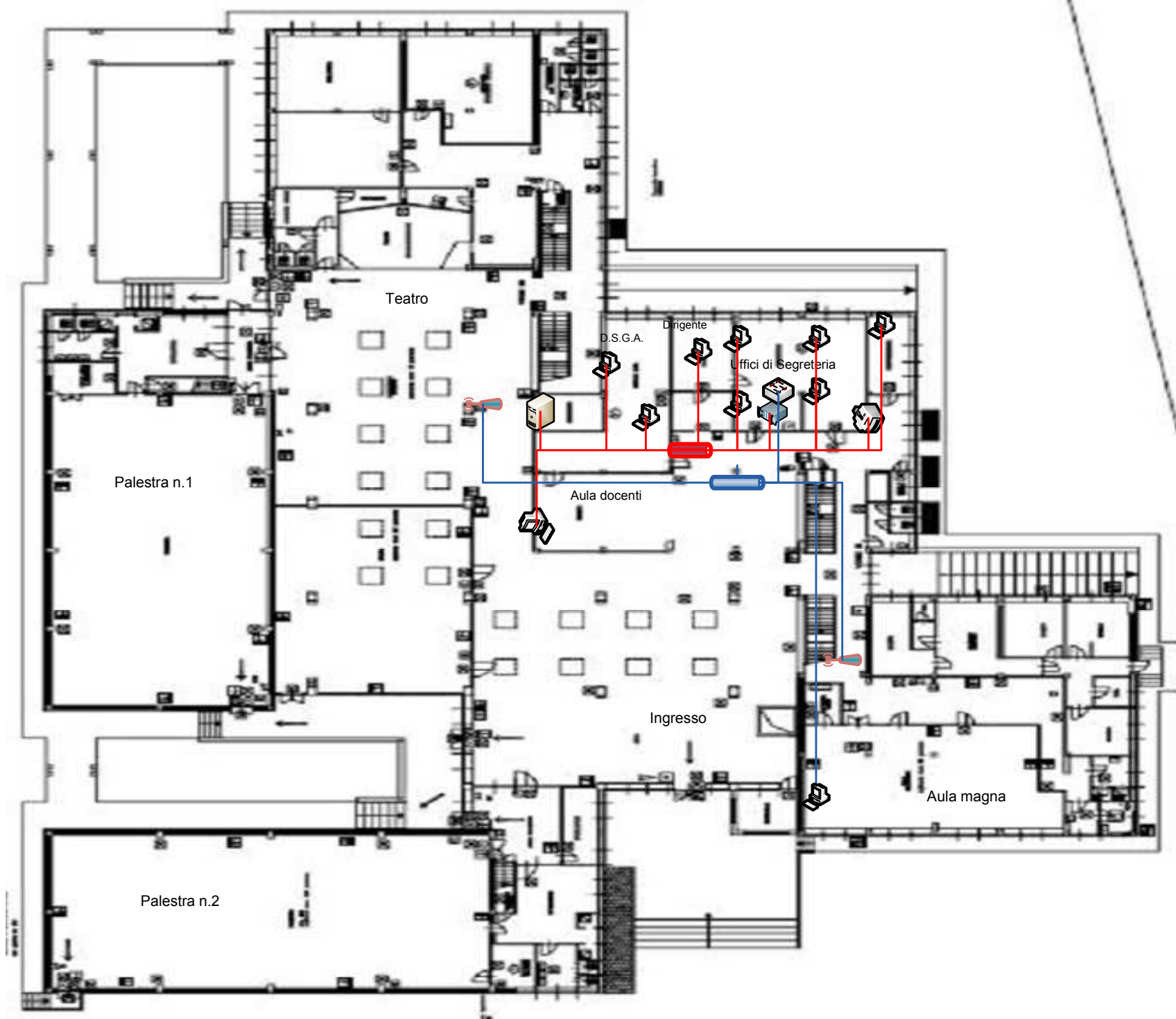

Armadio Rack già esistente

L'impianto non necessita di posa in opera di canaline per il passaggio dei cavi









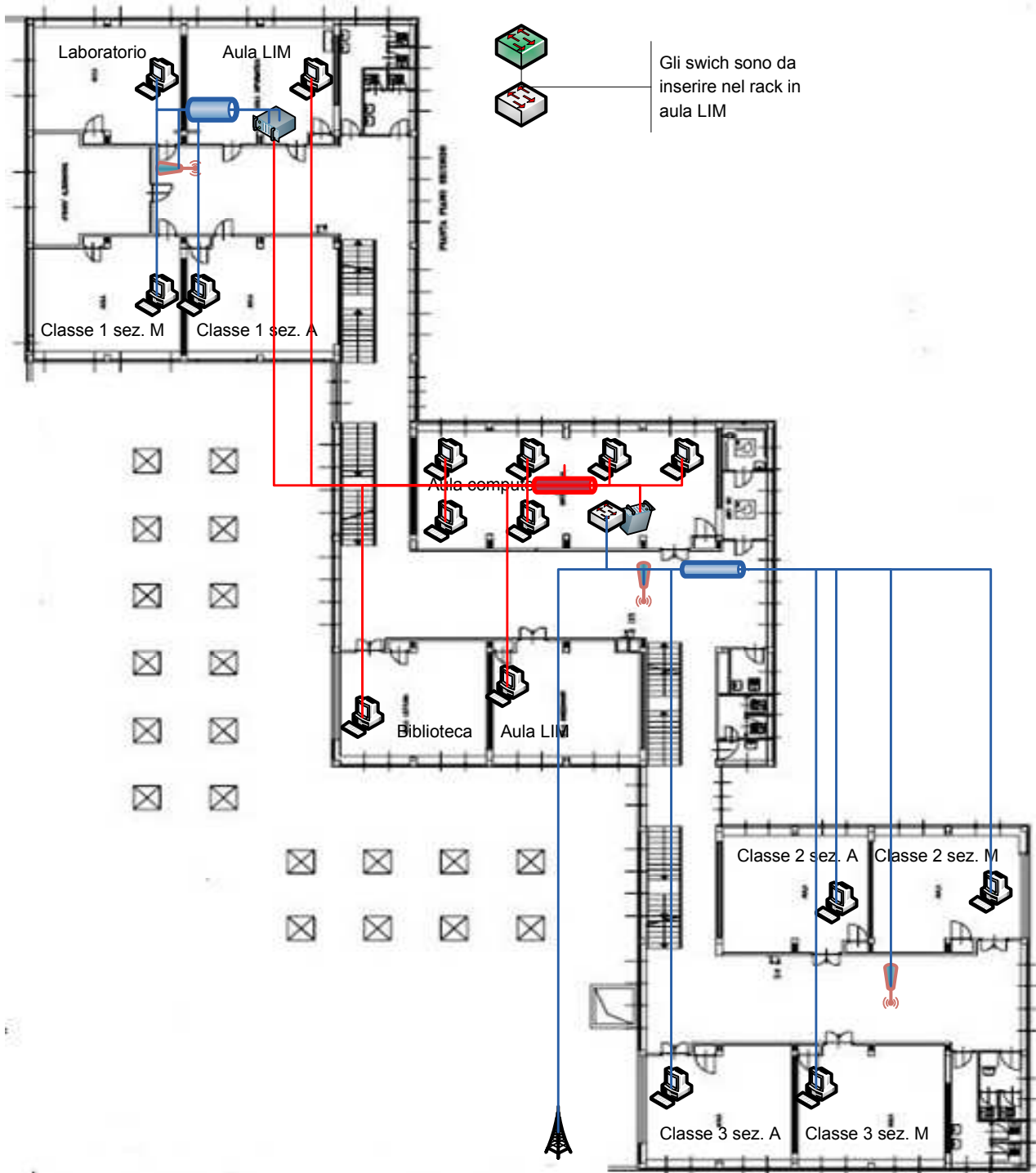









- Legenda:
-  Cavo di rete già cablato
 -  Stampante multifunzione
 -  Personal Computer
 -  Modem
 -  Cavo di rete cat. 6 da cablare
 -  Switch PoE+ 4 Porte
 -  Armadio Rack da installare
 -  Armadio Rack già esistente
 -  Access Point PoE dual Band
 -  Server (già presente)



Gli switch sono da inserire nel rack in aula LIM







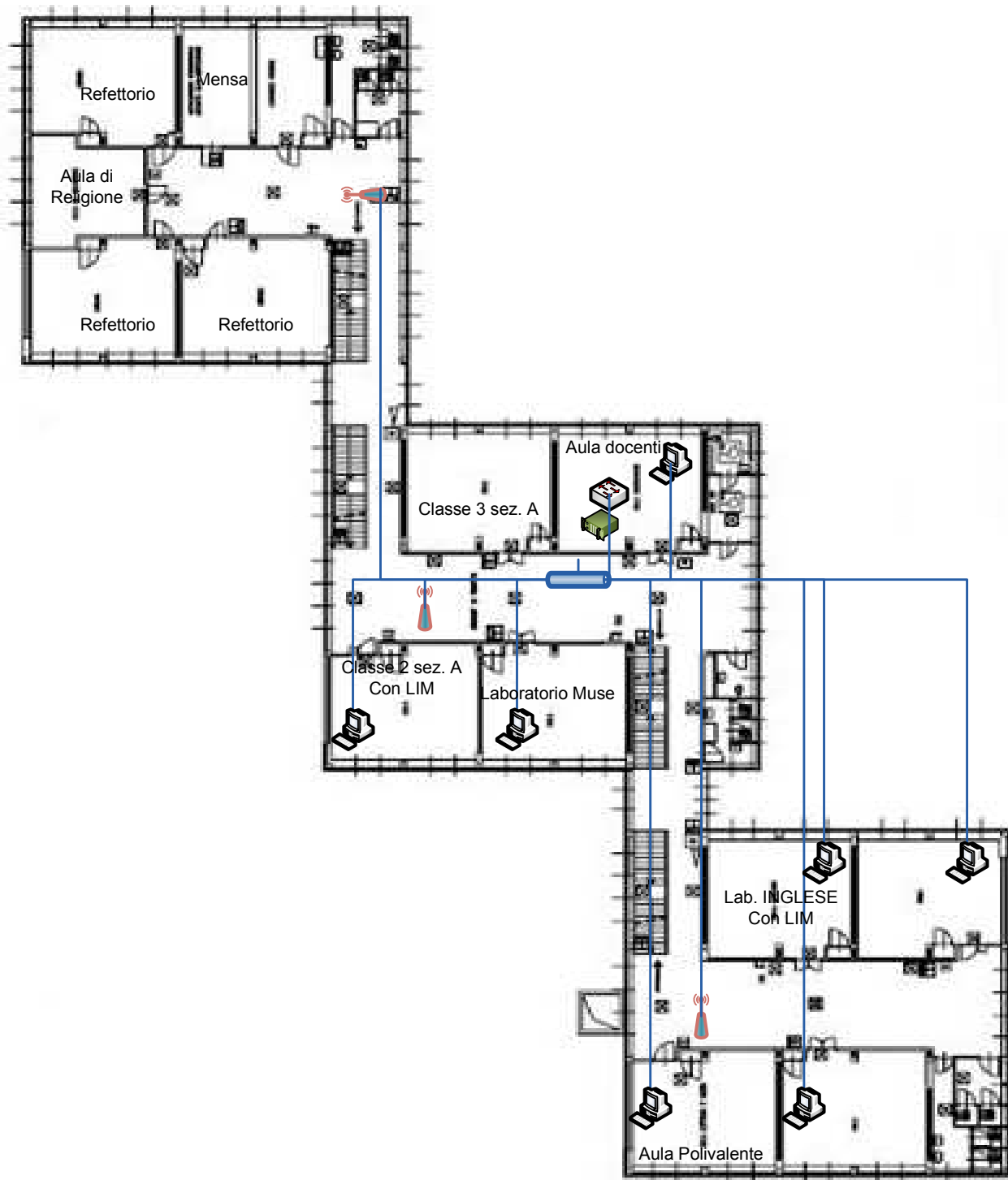

Legenda:

-  Cavo di rete già cablato
-  Stampante multifunzione
-  Personal Computer
-  Modem
-  Cavo di rete cat. 6 da cablare
-  Switch PoE+ 8 Porte
-  Armadio Rack da installare
-  Armadio Rack già esistente
-  Access Point PoE dual Band
-  Server (già presente)
-  Access Point da esterno PoE
-  Switch 16 porte già esistente

L'impianto non necessita di posa in opera di canaline per il passaggio dei cavi





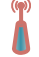



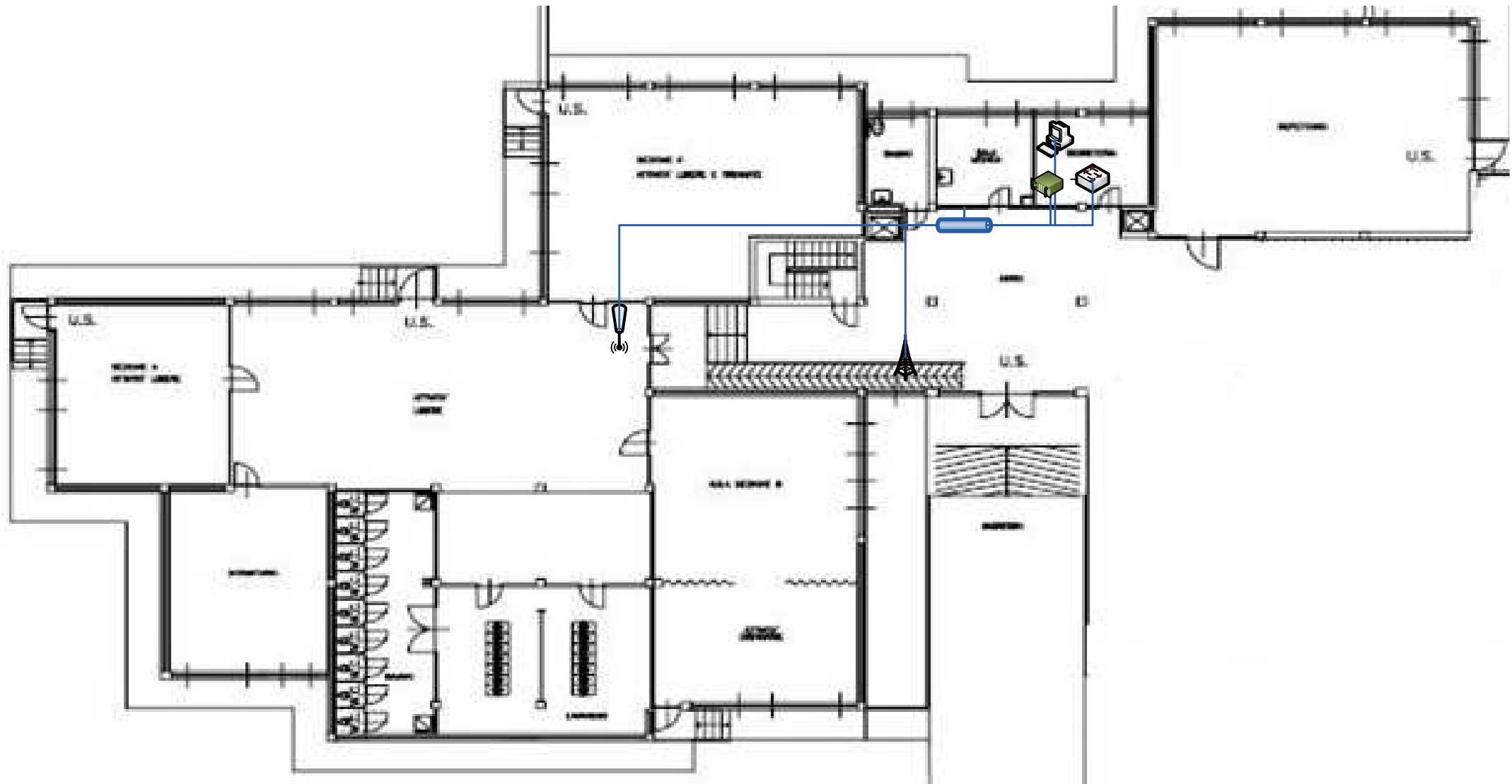



Legenda:

-  Cavo di rete già cablato
-  Stampante multifunzione
-  Personal Computer
-  Modem
-  Cavo di rete cat. 6 da cablare
-  Switch PoE+ 12 Porte
-  Armadio Rack da 6U con multipresa
-  Armadio Rack già esistente
-  Access Point PoE dual Band

L'impianto non necessita di posa in opera di canaline per il passaggio dei cavi

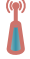

Legenda:

- | | | | | | |
|---|-------------------------|--|-----------------------------------|---|--|
|  | Modem |  | Armadio Rack da 6U con multipresa |  | Access Point da esterno PoE Configurato in modalità Client |
|  | Stampante multifunzione |  | Cavo di rete cat. 6 da cablare |  | Armadio Rack già esistente |
|  | Personal Computer |  | Switch PoE+ da 8 Porte |  | Access Point da esterno PoE |
| | | | |  | Cavo di rete già cablato |
| | | | |  | Access Point PoE dual Band DAP 2553 di proprietà |